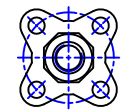
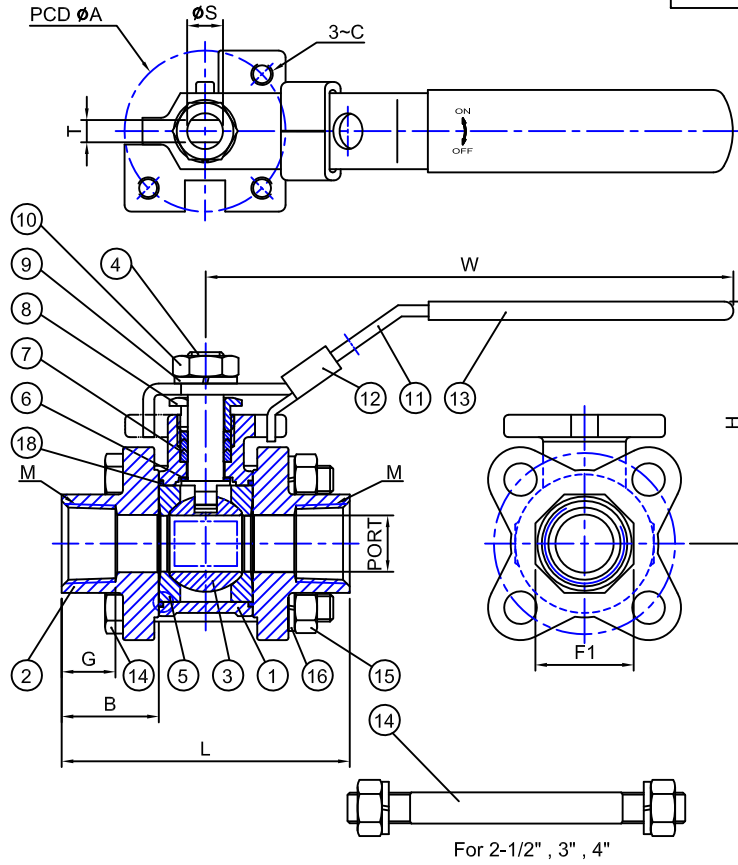
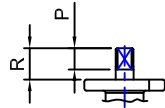
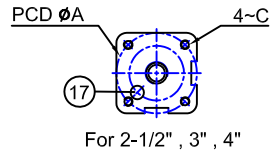
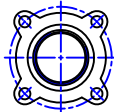

Fig No:

PB-3110M



For 1/4" ~ 2"



For 2-1/2"

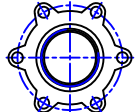

For 3"

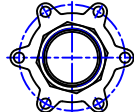

For 4"

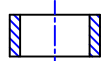

For 1/4" ~ 3/4"
GLAND PACKING



For 1-1/2" & For 4"
GLAND PACKING



For 3"
GLAND PACKING

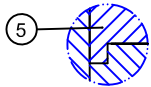

For 1/4" ~ 1/2"

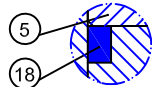

For 3/4" ~ 2"

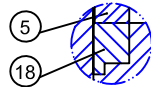

For 2-1/2" ~ 4"

DIMENSIONS

unit:mm

SIZE	PORT	F1	B	G	L	H	W	A	C	S	T	P	R	M	CV	Torque (kgf-cm)	Weight (kgs)	ISO5211
1/4"	12.6	22	21.7	12	64.4	55.3	118	36	3/16-24UNC	7.9	5	9.5	14	NPT	21	51	0.46	F03
3/8"	12.6	22	21.7	12	64.4	55.3	118	36	3/16-24UNC	7.9	5	9.5	14	NPT	24	51	0.44	F03
1/2"	15	27.2	21	13	64.6	58.4	137.7	36	3/16-24UNC	9.5	6.4	13.3	19.1	NPT	37	71.4	0.62	F03
3/4"	20	33.7	25.4	19.6	80.8	62.1	137.7	36	3/16-24UNC	9.5	6.4	13.3	18.9	NPT	68	102	0.84	F03
1"	25	40	28.3	18	94.9	83.9	161	42	3/16-24UNC	11.1	7.9	18	24.9	NPT	109	153	1.26	F04
1-1/4"	32	48.6	30.2	19	109.7	92.1	161	50	1/4-20UNC	11.1	7.9	18	24.4	NPT	185	214.1	2.27	F05
1-1/2"	38	55.5	35.7	25	129.6	96.7	192.6	50	1/4-20UNC	12.7	8.9	18.7	26.4	NPT	268	356.9	2.76	F05
2"	50.8	67.6	38.4	27	148.7	112	204.5	70	5/16-18UNC	12.7	8.9	18.7	27.2	NPT	486	571	4.32	F07
2-1/2"	65	Ø88	48.5	34	183	139.5	277	102	5/16-18UNC	19	12	27.5	43	NPT	843	764.7	9.08	F10
3"	80	Ø104	54.5	41	209	150.5	322	102	7/16-14UNC	19	12	27.5	37	NPT	1150	1121.6	14.46	F10
4"	100	128.5	55	39	235	168.7	322	102	7/16-14UNC	25.4	16	39.3	52	NPT	1932	2549.1	23.66	F10

MATERIAL LIST

NO.	PART NAME	MATERIAL	Q'TY
		STAINLESS STEEL	
1	BODY	A351-CF8M	1
2	CAP	A351-CF3M	2
3	BALL	A351-CF8M	1
4	STEM	SS316	1
5	SEAT	RPTFE	2
6	THRUST WASHER	PTFE	1
7	STEM PACKING	PTFE	1SET
8	GLAND NUT	SS304	1
9	SPRING WASHER (1)	SS304	1
10	NUT (1)	SS304	1
11	HANDLE	SS304	1
12	LOCKING PAD	SS304	1
13	HANDLE COVER	PLASTIC	1
14	BOLT	B8M	4~6
15	NUT (2)	8M	4~12
16	SPRING WASHER (2)	SS316	4~12
17	SET SCREW	SS304	1
18	GASKET	PTFE	2

